

SAGOLA ®
an Elcometer company



***New air-assisted airless generation.
More performance. More control.***

NEW AIR-ASSISTED AIRLESS RANGE

SAGOLA presents its new generation of high-performance hybrid spray guns for the most demanding industrial environments. Power, precision and control come together in the new X3500 and X4500 Mix models, designed to deliver maximum transfer efficiency and superior atomisation, even with high-viscosity materials.

A robust and contemporary aesthetic is combined with an optimised ergonomic design, achieving the perfect balance between strength and handling. Their carefully engineered weight distribution, together with high-precision machining, ensures comfort during long working sessions and a stable, uniform and professional application.

With these models, SAGOLA expands its range to meet new industrial application challenges, offering versatile solutions for a wide variety of coatings: primers, surfacers, industrial enamels and high-performance materials.

The new X3500 and X4500 Mix models are developed under SAGOLA's core principles of maximum manufacturing quality, high durability and easy maintenance, ensuring competitiveness, reliability and the best after-sales service. All of this while meeting the most stringent standards in manufacturing and material efficiency.

SAGOLA Professional Solution for All Applications

The new Sagola X3500 and X4500 Mix models are designed to deliver maximum atomisation and control in demanding applications. Balanced and robust, they ensure stability with every pass and consistent performance, even with high-viscosity materials. The perfect combination of pressure and air to achieve uniform, efficient and professional finishes.

POWER AND SUPERIOR ATOMISATION

Hybrid technology combines fluid pressure and air assistance to achieve fine atomisation even with high-viscosity materials. Greater transfer efficiency, uniform application and high-quality finishes in demanding industrial environments.

ROBUSTNESS AND INDUSTRIAL RELIABILITY

Built with high-strength materials and precision machining, the X3500 and X4500 Mix models are designed to withstand long working hours and extreme conditions, ensuring consistent performance and extended service life.

CONTROL AND STABILITY IN EVERY PASS

Their balanced ergonomic design and optimal weight distribution provide comfortable and safe handling. The applicator achieves a consistent and stable spray pattern, reducing fatigue, overspray and rework.

EASY MAINTENANCE AND MAXIMUM DURABILITY

Designed with metal-to-metal contact in critical fluid areas, eliminating unnecessary seals in the application zone. Easy disassembly, quick cleaning and reduced component wear to minimise downtime.



TECHNICAL SPECIFICATIONS





TECHNICAL SPECIFICATIONS

	Sagola X3500 Mix		Sagola X4500 Mix	
Weight	510 g.	1.1 lbs	602 g.	1.32 lbs
Weight (with swivel connector)	550 g.	1.98 lbs	642 g.	1.41 lbs
Dimensions (with swivel connector)	16.1 x 3.2 x 20.1 cm. 6.3 x 1.3 x 7.9 inches		16.1 x 4.2 x 19.9 cm. 6.3 x 1.6 x 7.8 inches	
Air inlet connection	Quick connector 8 mm. / M16		Quick connector 8 mm. / M16	
Product inlet connection	BSP 1/4" M		BSP 1/4" M	
Recommended working pressure	2 bar	29 psi	2 bar	29 psi
Product filter	60 / 100 meshes		60 / 100 meshes	
Average sound pressure level	max. 80 dB			
Materials in contact with the product	Anodised aluminium, chrome-plated aluminium, POM, stainless steel, Teflon and nylon			



VERSIONS *Spray Gun* CODES

SPRAY GUNS CODES

Hybrid TIP	Air Inlet	Product inlet	Code Sagola X3500 Mix	Code Sagola X4500 Mix
11/40	8 mm. Quick connector	Swivel connector BSP 1/4" M 	35130211	35130701
	M16 fitting		35130213	35130703
13/40	8 mm. Quick connector	Swivel connector BSP 1/4" M 	35130215	35130705
	M16 fitting		35130217	35130707
11/40	8 mm. Quick connector	BSP 1/4" M	35130210	35130702
	M16 fitting		35130212	35130704
13/40	8 mm. Quick connector	BSP 1/4" M	35130214	35130706
	M16 fitting		35130216	35130708



ACCESSORIES

ACCESSORIES

Description	Code
AAA swivel head (X4500 Mix)	81450000
Filter holder (1/4" - 3/8") + Mesh filter (100 + 60)	56418057
100 mesh filter (10 units)	56418053
60 mesh filter (10 units)	56418054
100-sheet filter	83660037
Tip microfilters (10 units)	30010015
Filter holder	56410104
Product tube kit	56418615



AIR-ASSISTED AIRLESS TIPS APPLICATIONS

	TIP Description		Orifice (inches / mm.)	Angle	Fan width at 30 cm.	Water flow rate a 100 bar	Fixed TIP Code	Swivel TIP Code Standard	Swivel TIP Code LP/FF
	Fixed	Swivel							
FINISHES LACQUERS ENAMELS RELEASE AGENTS	09 / 20	290	0.009" / 0.23	20°	100-150 mm.	0.25 L/min.	81460518	81450209	81451209
	09 / 40	409	0.009" / 0.23	40°	200-250 mm.	0.25 L/min.	81460519	81450409	81451409
	09 / 60	609	0.009" / 0.23	60°	300-355 mm.	0.25 L/min.	81460521	81450609	81451609
	11 / 20	211	0.011" / 0.28	20°	100-150 mm.	0.37 L/min.	81460527	81450211	81451211
	11 / 40	411	0.011" / 0.28	40°	200-250 mm.	0.37 L/min.	81460529	81450411	81451411
	11 / 50	-	0.011" / 0.28	50°	250-300 mm.	0.37 L/min.	81460530	-	-
	11 / 60	611	0.011" / 0.28	60°	300-355 mm.	0.37 L/min.	81460528	81450611	81451611
	-	811	0.011" / 0.28	80°	405-457 mm.	0.37 L/min.	-	81450811	81451811
URETHANES ACRYLICS SURFACERS AND PRIMERS	13 / 20	213	0.013" / 0.33	20°	100-150 mm.	0.57 L/min.	81460539	81450213	81451213
	13 / 30	-	0.013" / 0.33	30°	150-200 mm.	0.57 L/min.	81460537	-	-
	13 / 40	413	0.013" / 0.33	40°	200-250 mm.	0.57 L/min.	81460540	81450413	81451413
	13 / 50	-	0.013" / 0.33	50°	250-300 mm.	0.57 L/min.	81460541	-	-
	13 / 60	613	0.013" / 0.33	60°	300-355 mm.	0.57 L/min.	81460542	81450613	81451613
	13 / 80	813	0.013" / 0.33	80°	405-457 mm.	0.57 L/min.	81460543	81450813	81451813
SURFACERS AND PRIMERS	15 / 20	-	0.015" / 0.38	20°	100-150 mm.	0.72 L/min.	81460539	-	-
	15 / 40	415	0.015" / 0.38	40°	150-200 mm.	0.72 L/min.	81460537	81450415	81451415
	15 / 50	-	0.015" / 0.38	50°	200-250 mm.	0.72 L/min.	81460540	-	-
	15 / 60	615	0.015" / 0.38	60°	250-300 mm.	0.72 L/min.	81460541	81450615	81451615
	15 / 80	815	0.015" / 0.38	80°	300-355 mm.	0.72 L/min.	81460542	81450815	81451815
SURFACERS ANTI-CORROSIVE PRIMERS HIGH-VISCOSITY MATERIALS	16 / 50	-	0.016" / 0.41	50°	100-150 mm.	0.91 L/min.	81460539	-	-
	-	417	0.017" / 0.43	40°	150-200 mm.	0.93 L/min.			
	18 / 40	-	0.018" / 0.46	40°	150-200 mm.	1.10 L/min.	81460537	-	-
	18 / 60	-	0.018" / 0.46	60°	200-250 mm.	1.10 L/min.	81460540	-	-
	21 / 40	421	0.021" / 0.53	40°	250-300 mm.	1.52 L/min.	81460541	81450421	81451421
	21 / 80	821	0.021" / 0.53	80°	300-355 mm.	1.52 L/min.	81460542	81450821	81451821

Both the fluid delivery and the fan size in pressure spray guns are directly related to the fluid pressure set by the user, the viscosity of the material and the characteristics of the hose. Therefore, no reference value can be established.

SAGOLA WARRANTY

SAGOLA offers a **3-year warranty** across its entire range, covering any design or manufacturing defects in its products. Any defect in design will be grounds for repair or replacement of the product at no cost to the customer.

SAGOLA is synonymous with **quality and service**. For this reason, SAGOLA provides a comprehensive spare parts and service guarantee, ensuring the proper maintenance of all its products, even those sold more than 10 years ago.

X3500 Mix

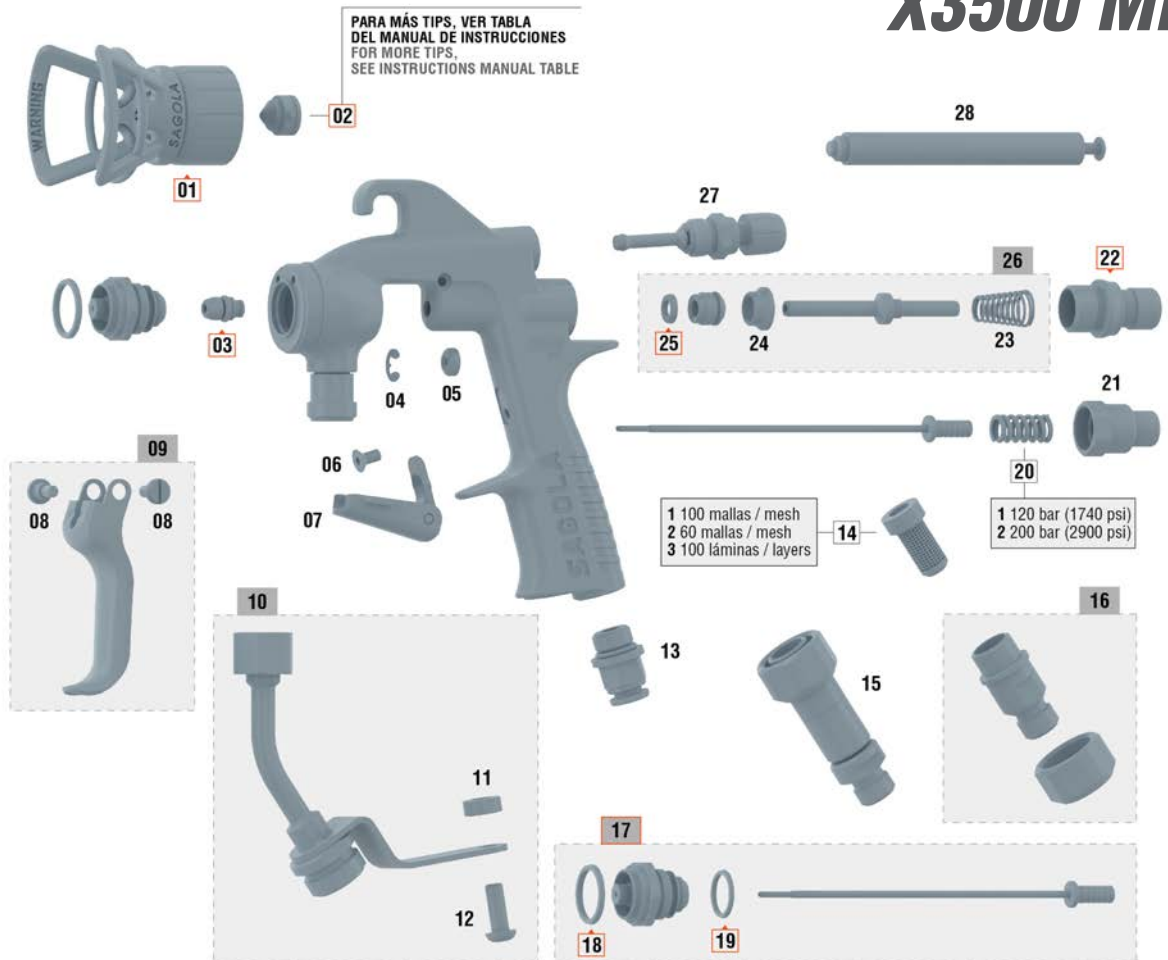

00 REPUESTOS RECOMENDADOS PARA EL MANTENIMIENTO DE LA PISTOLA
RECOMMENDED PARTS FOR SPRAY GUN MAINTENANCE

Nº	Código	Ud.	Nº	Código	Ud.	Nº	Código	Ud.	Nº	Código	Ud.	Nº	Código	Ud.
01	56418791	1	08	57250415	2	14/2	56418054	1	20/1	54710288	1	26	56418612	1
02	81460529	1	09	56418613	1	14/3	83660037	1	20/2	54710289	1	27	56415256	1
03	56418614	1	10	56418615	1	15	56410110	1	21	57810343	1	28	50210214	1
04	50850605	1	11	51910235	1	16	56418046	1	22	56411624	1			
05	51910623	1	12	57251904	1	17	10011250	1	23	54710312	1			
06	57251403	1	13	55751810	1	18	54251011	1	24	54110012	1			
07	56413707	1	14/1	56418053	1	19	50810258	1	25	50810202	1			

REMEMBER: Always use original SAGOLA spare parts and accessories to ensure the correct operation of your spray equipment

SAGOLA WARRANTY

X4500 Mix

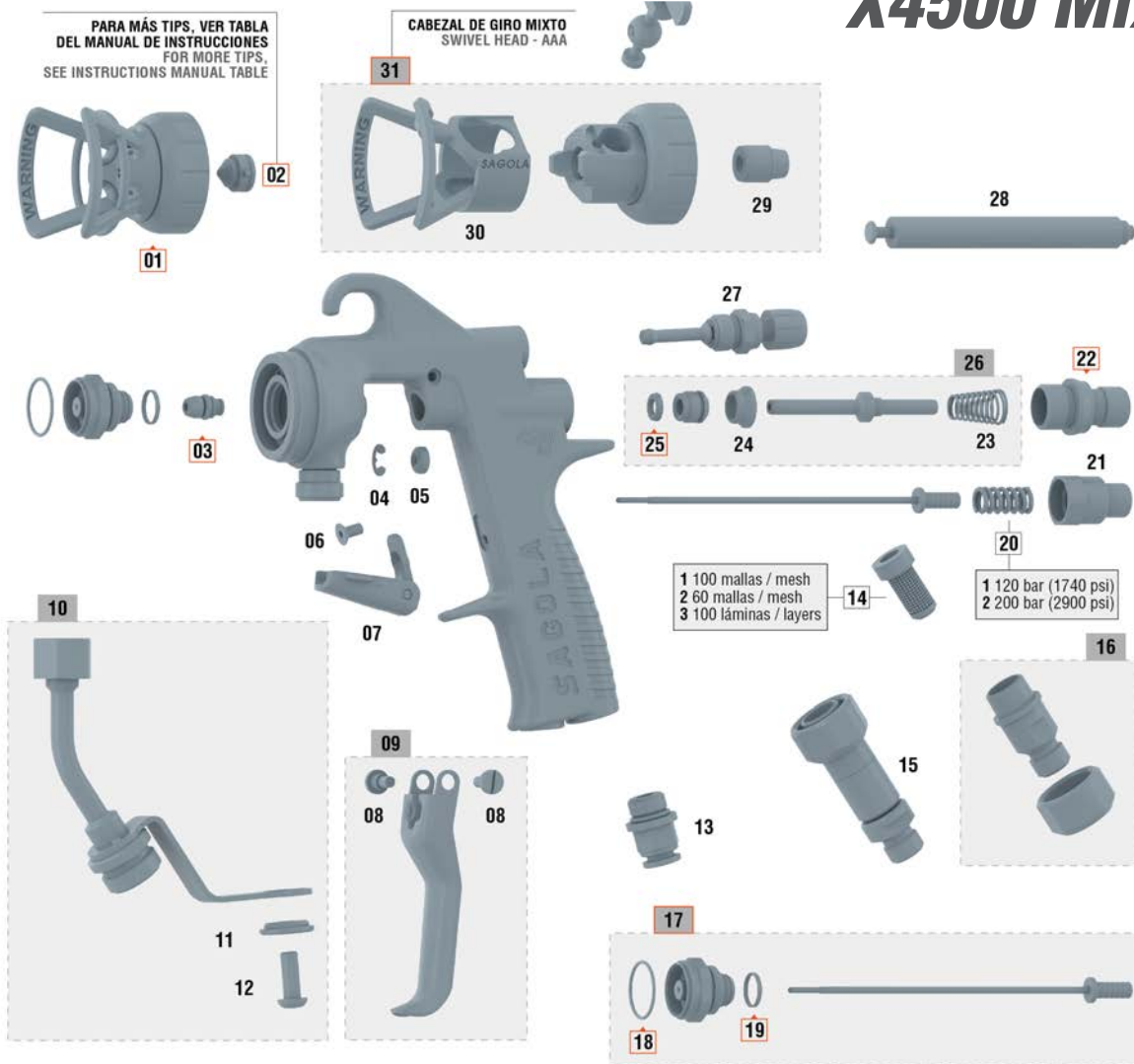

00 REPUESTOS RECOMENDADOS PARA EL MANTENIMIENTO DE LA PISTOLA
RECOMMENDED PARTS FOR SPRAY GUN MAINTENANCE

Nº	Código	Ud.	Nº	Código	Ud.	Nº	Código	Ud.	Nº	Código	Ud.	Nº	Código	Ud.
01	56418790	1	08	57250415	2	14/2	56418054	1	20/1	54710288	1	26	56418612	1
02	81460529	1	09	56418785	1	14/3	83660037	1	20/2	54710289	1	27	56415256	1
03	56418614	1	10	56418784	1	15	56410110	1	21	57810343	1	28	50210214	1
04	50850605	1	11	51911116	1	16	56418046	1	22	56411624	1	29	54110013	1
05	51910623	1	12	57251904	1	17	10011296	1	23	54710312	1	30	30010211	1
06	57251403	1	13	55751810	1	18	54251050	1	24	54110012	1	31	81450000	1
07	56413707	1	14/1	56418053	1	19	50810258	1	25	50810202	1			

MORE FROM SAGOLA

AIR AND PRODUCT HOSE



High-pressure hose for hybrid spray systems.
Air hose: 6 x 8 mm (version for spray guns with quick connector) and 8 x 10 mm (version for spray guns with M16 connection). Fluid hose BSP 1/4" F, with nylon cover.

AIR-ASSISTED AIRLESS PUMPS

Pump range designed and manufactured exclusively for professional use, meeting the highest performance standards.



SAGOLA S.A.U. will refuse any responsibility for the damage of defects caused by spray guns with a similar appearance to the originals.

These guns are imitations that **HAVE NOT BEEN MANUFACTURED BY SAGOLA, S.A.U.**

The SAGOLA S.A.U. products are exclusively sold through our distributors, with spare parts and a 3-year worldwide guarantee against design and/or manufacturing defects.

SAGOLA S.A.U. has always displayed the quality of its products with pride, but lately, in view of its ever more demanding clients, it has obtained certifications that vouch for the guarantee of its know-how and its impeccable organisational quality.

